

Fuel Pump

Testing

CAUTION: Be sure to turn the ignition switch OFF before disconnecting the coupler.

Confirm that the operation noise of the fuel pump is generated for approximately two seconds when the ignition switch is turned ON.

If the pump does not make the operation noise, carry out the inspection described below:

1. Check that the battery voltage can be detected just when the ignition switch is turned ON at the fuel pump wire couplers. (Positive probe to the yellow wire, negative probe to the black wire)

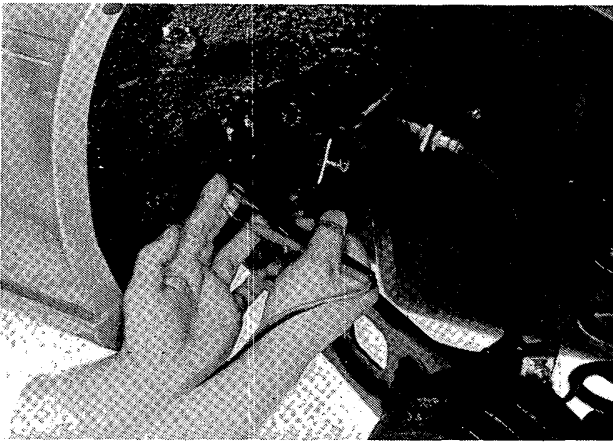

- If the battery voltage is detected, replace the fuel pump.
- If there is no voltage, check the main relay and the wire harness.

Output Test

WARNING Do not smoke during the test. Keep any open flame away from your work area.

1. With the ignition switch OFF, disconnect connector from main relay.
2. Connect the yellow and black/yellow wires together using a jumper wire.

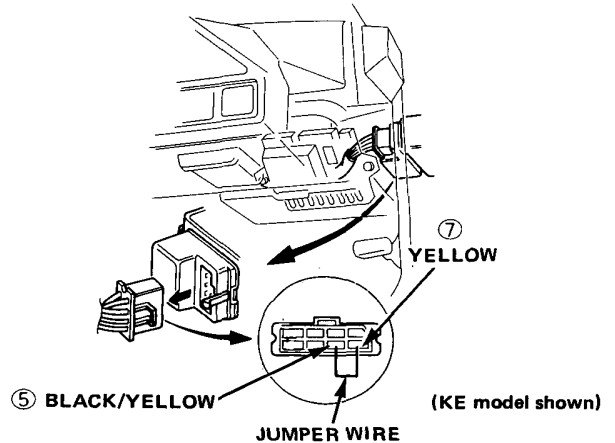

3. Relieve fuel pressure. (See page 11-25)
4. Disconnect fuel return hose at pressure regulator and connect a hose for measurement to it and hold a graduated container under the hose.
5. Turn ignition ON, measure amount of full flow for 10 seconds, then turn ignition OFF.

Fuel flow should be more than 230 cm^3 (7.8 oz.) in 10 seconds with battery voltage at 12 volts.

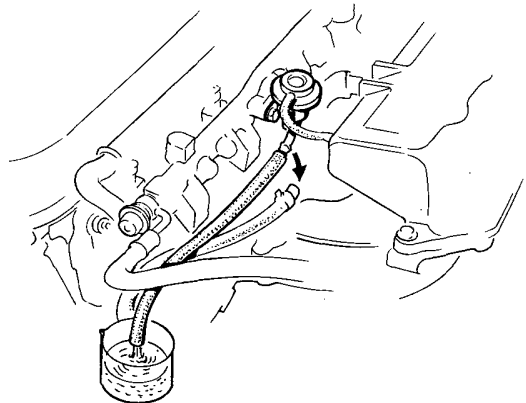

If fuel flow is less than 230 cm^3 (7.8 oz.);

- Fuel pump failure
- Clogged fuel filter
- Clogged fuel pipe
- Pressure regulator failure



Main Relay

Replacement

WARNING

- Do not smoke while working on fuel system. Keep open flame away from work area.
- Block front wheels before jacking up rear of car.

1. Jack up rear of car and place jack stands in proper locations.
2. Remove left rear wheel.
3. Remove the fuel pump cover.
4. Disconnect fuel lines and electrical leads at the fuel pump.
5. Removing three bolts, remove fuel pump with mount.

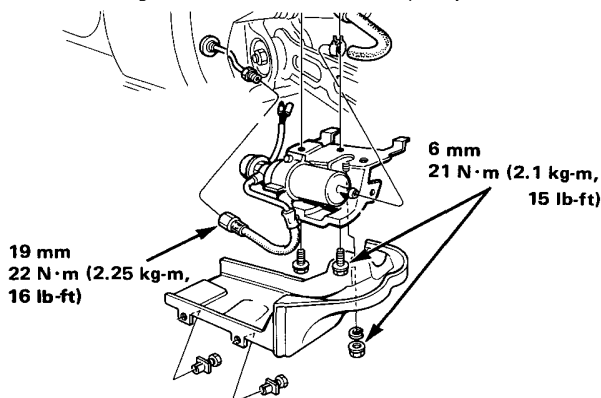

NOTE:

- When assembling the flare joint part, clean the joint area and coat its screw part with new engine oil. (Assemble the joint soon after engine oil is applied to it.)
- Bring the sealing surfaces into proper contact, tighten the flare nut.
- After the installation work is completed, turn the ignition switch ON. (Do not operate the starter) As the fuel pump is operated for approximately two seconds, the fuel pressure in the fuel line rises. Repeat this operation two to three times, and check whether there is any leakage of fuel in the fuel line.

Silencer Replacement

1. Remove the fuel line and the silencer from the pump.

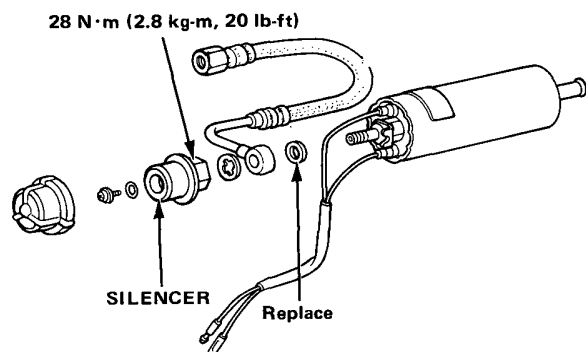

CAUTION: Do not disassemble the pump

Testing

1. Remove the main relay located under the dash.
2. Connect the battery positive terminal to the No. 4 terminal and the battery negative terminal to the No. 8 terminal of the main relay.
3. Check that there is continuity between the No. 5 terminal and the No. 7 terminal of the main relay.
4. Connect the battery positive terminal to the No. 5 terminal and the battery negative terminal to the No. 2 terminal of the main relay.
5. Check that there is continuity between the No. 1 terminal and the No. 3 terminal of the main relay.
6. Connect the battery positive terminal to the No. 3 terminal and the battery negative terminal to the No. 8 terminal of the main relay.
7. Check that there is continuity between the No. 5 terminal and the No. 7 terminal of the main relay.

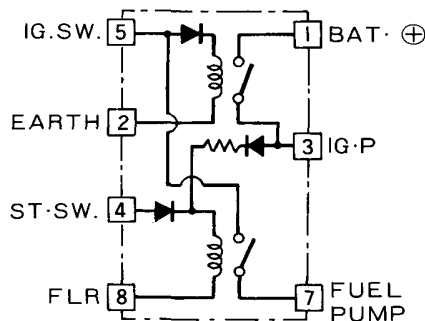
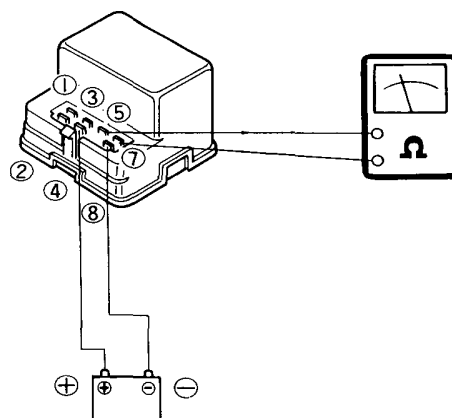

If there is no continuity, replace the main relay.